



窓의 새로운 표준



Head Office | 10028, 42-30 Daegotbuk-ro 305beon-gil, Daegot-myeon, Gimpo-si, Gyeonggi-do, Korea

TEL : +82-31-984-2349(代) FAX : +82-31-984-4777

Seoul Office | 07205, 1201, Kolon Digital Tower, 21, Yangpyeong-ro 22-gil, Yeongdeungpo-gu, Seoul, Korea

TEL : +82-70-7605-1972 FAX : +82-2-2062-5112

www.sonusys.co.kr



SONUSYS

creates new window culture

Eco-friendly / Energy-saving

New Standards for Window

The world's first new technology
"Hidden Rail System"



CONTENTS

Company Profile

Curtain Wall

Sliding Window

Certification

Reference Projects



CEO MESSAGE

SONUSYS forms a new window standard

With diverse damages resulting from rapidly changing weather conditions, global energy-saving policies and consumers' desire for high standards, there has been a rising demand for high-performance window systems.

Recently, a free trade agreement (FTA) has been signed with countries. Under these circumstances, unless we properly respond to such requests and overcome the limitations of current window systems, the Korean window market would soon be taken over by high-quality foreign window systems.

To keep pace with these global trends, we have worked hard to develop Korean window systems with our own technology. With such strenuous efforts, we have finally developed the Hidden Rail Window System (HRWS) and obtained New Excellent Technology (NET) and New Excellent Product (NEP) certifications for the first time in the Korean window industry.

With the HRWS, we have dramatically improved five basic window performances (insulation, airtightness, water tightness, sound insulation, wind resistance). Armed with innovative design, cleanliness and high safety, we also are now competing with the world's leading window manufacturers.

We promise that we will keep moving forward until our window system will become a global standard.

Park Myung-shin

CORPORATE CHRONOLOGY

Through **continued R&Ds** on system windows and curtain walls since 2001, SONUSYS now has the world's finest technology.



BUSINESS FIELDS

Curtain Wall | Sliding Window | System Door | System Window

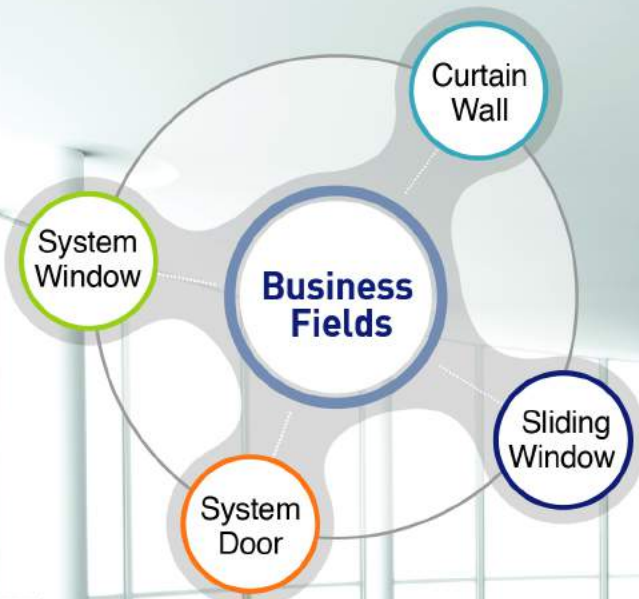

ORGANIZATION

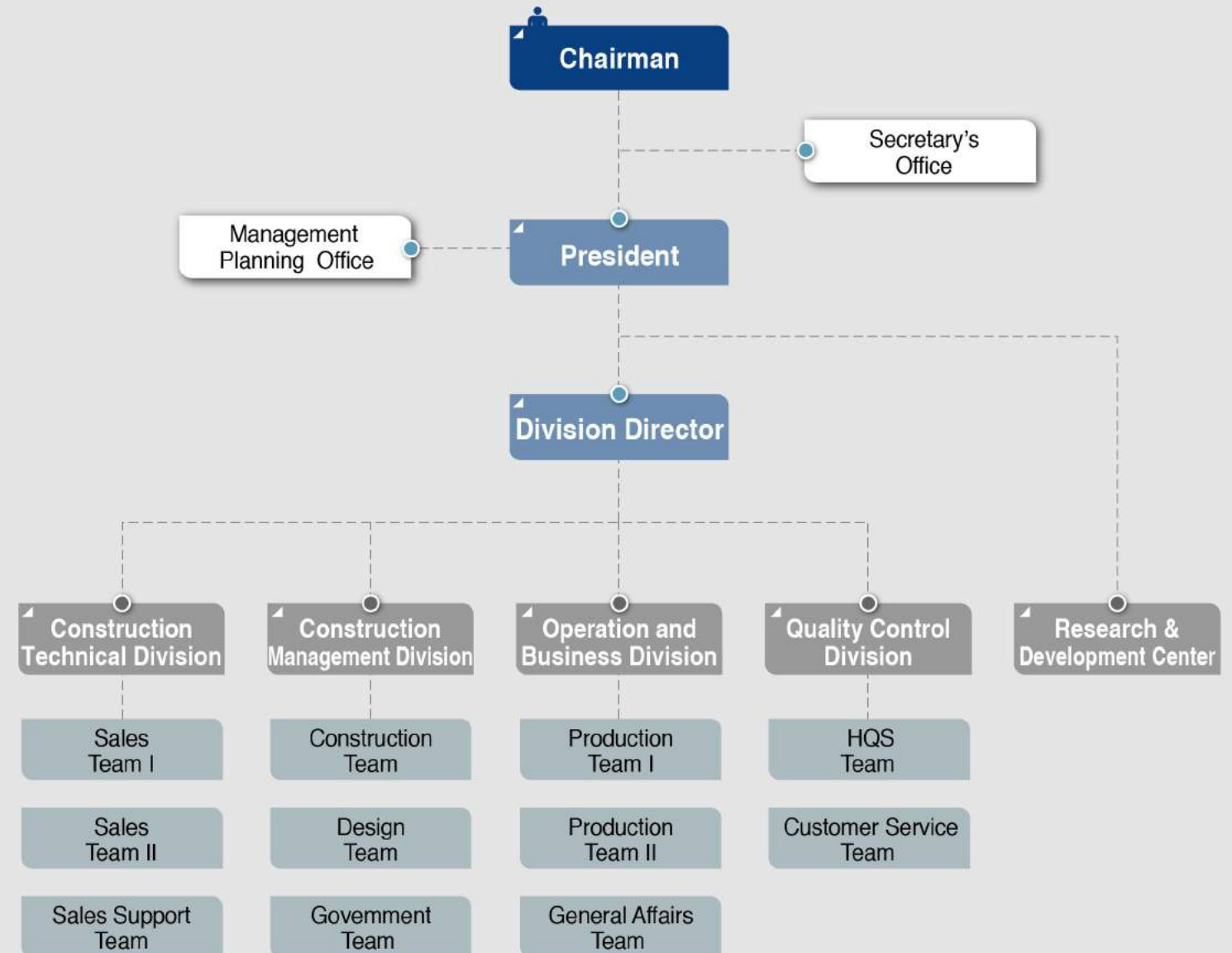

SONUSYS SYSTEM WINDOW

CURTAIN WALL

The insulated curtain wall offers highly insulated energy-saving models and eco-friendly series which are designed to reduce energy consumption. We actively respond to diverse construction environments to meet our clients' diverse needs through one-stop solution from development to design, production and construction.

CONTENTS

Excellent Product

Cap Type, Hidden Type

Project Window



| Korea Polar Research Institute |

Excellent Product

Structure Comparison

	SONUSYS	Others
Structure	<ul style="list-style-type: none"> The main frame separated from the glass support; flexible structure Double thermal break 	<ul style="list-style-type: none"> Main frame and glass support integrated Single thermal break
Design & Price	<ul style="list-style-type: none"> Diverse design in various project & optimal price 	<ul style="list-style-type: none"> Fixed design in various project & low price

Overview

Frame	Material	Purposes	Certification
150~260mm	Aluminum	Office Building	

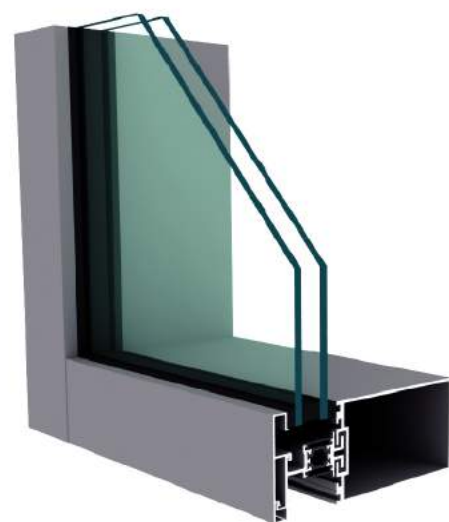

Easy and convenient innovative **insulated curtain** wall in diverse design

- Structure of double thermal break
- Design Diversity
- Optimal Price

Detail Drawing

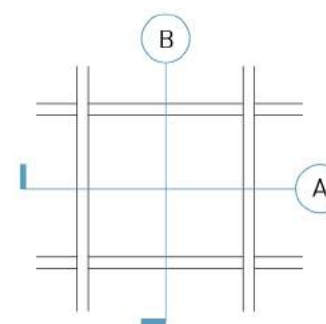

| KEY ELEVATION |

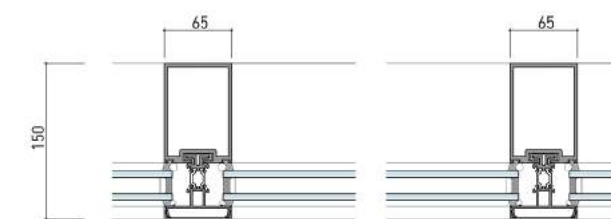

| HORIZONTAL SECTION |

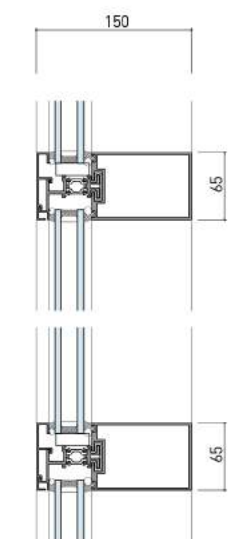

| VERTICAL SECTION |



Yeoncheon-gun Multipurpose Welfare Center Construction Project

Cap Type Curtain Wall

Sectional View



| 120mm |



| 150mm |



| 180mm |

Overview

Frame	Material	Purposes	Certification
120~240mm	Aluminum	Office Building	   



Insulated **aluminum curtain wall**
making the building more refined
and beautiful

- Excellent Energy Performance
- Adjusting in high rise building
- Beautiful Facade

Detail Drawing

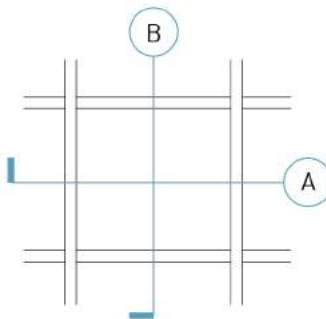

| KEY ELEVATION |

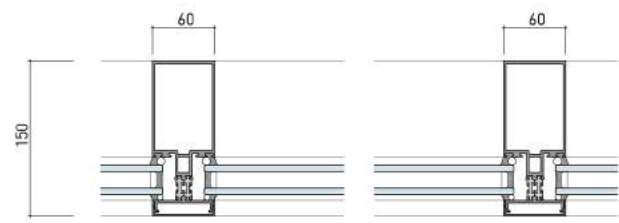

| HORIZONTAL SECTION |

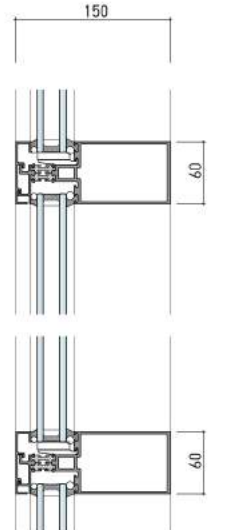

| VERTICAL SECTION |



Yangjae 2-dong Community Service Center

Hidden Type Curtain Wall

Sectional View



| 137mm |



| 150mm |



| 180mm |

Overview

Frame	Material	Purposes	Certification
137~180mm	Aluminum	Office Building	   



Aluminum hidden-insulating curtain wall making the facade more stylish

- Structural stability
- Flexible frame design

Detail Drawing

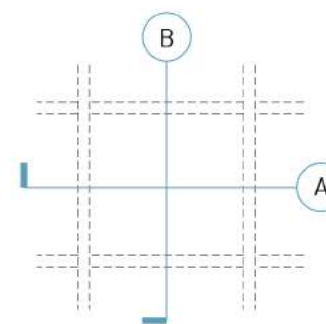

| KEY ELEVATION |

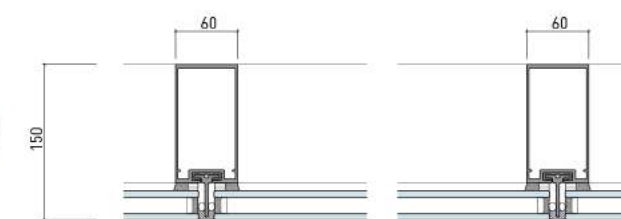

| HORIZONTAL SECTION |

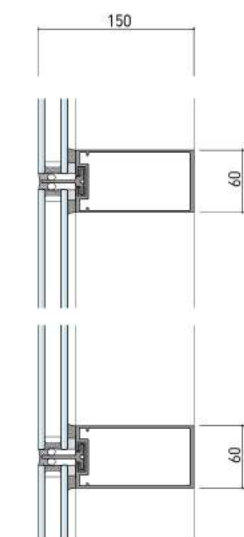

| VERTICAL SECTION |



Seohae 5-do Fisheries Cultural Complex

Project Window

Features

1. Project Window: The window is pushed open by the handle; easy repair and maintenance
2. Casement: The window is pushed open with a hinge attached to the middle; maximum opening for ventilation
3. Pull-down: Reverse project window; ventilation in convection current; usually installed in the kitchen or curtain wall

Product Description



| Project |



| Casement |



| Pull Down |

Overview

Frame	Material	Purposes	Certification
53mm	Aluminum	Office Building	



Insulating project window ensuring neat and clean facade with a broad view of the inside

- Great insulation with double thermal break structure
- Excellent insulating, air-tightness and sound-insulation effects with the adoption of special gasket
- Great outside view and space with simple design

Detail Drawing

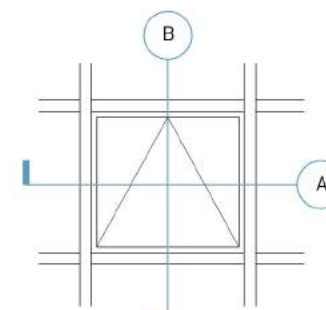

| KEY ELEVATION |

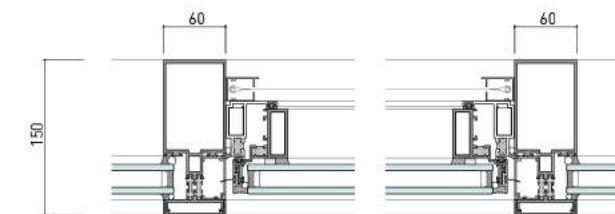

| HORIZONTAL SECTION |

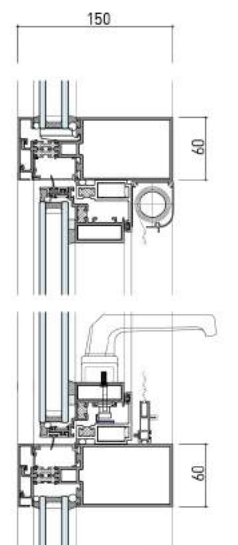

| VERTICAL SECTION |

SONUSYS SYSTEM WINDOW

SLIDING WINDOW

Clean plane structure covering the rail with a rail cover
This innovative Hidden Rail System Window improves
façade and key performances such as insulation,
air tightness, water tightness, wind resistance and
anti-condensation.

CONTENTS

Hidden Rail System Window

Premium Sliding Window

General Sliding Window

Hidden-Rail System Window



World Best Technology Hidden-Rail System Window

Hidden Rail System

Nomal Window

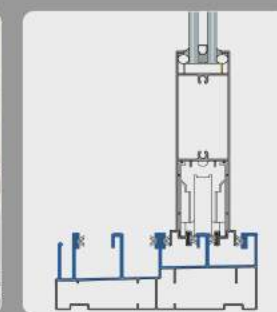
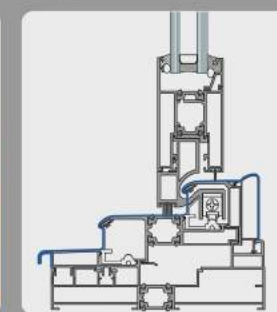

Bottom

Section

Bottom

Section

Insulating bars are applied

Maximizing insulating effects by strengthening the advantages of aluminum such as durability with the adoption of insulating bars

Insulating bars



Auto drainage of rainwater

The world's first stair-style plane structure system which automatically drains rainwater on the frame; The best water tightness effects and refined design

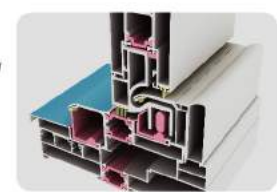

Effective in blocking sound and winding wind from gaps with specially designed sealing structure

Quiet and pleasant indoor space by effectively blocking wind and sound with multi-tight structure and TPV gasket and specially designed sealing parts

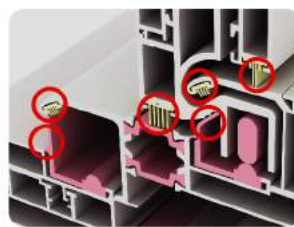

The windows non-removable force

Stays secure and safe even against strong storms since the windows cannot be removed by force with the rail cover



Quick and easy cleaning with a simple wipe!

When rainwater is drained out, dirt and bugs are removed as well, keeping the window clean. Quick and easy cleaning with a simple wipe!



Only one good choice – Enjoy it forever

If any damage occurs, the damaged part only can be replaced; easy maintenance
Semi-permanent and cost-efficient

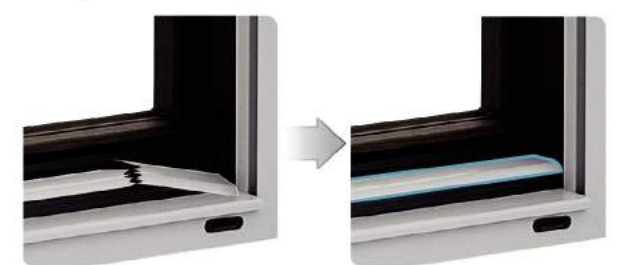

If broken

The damaged part replaced

Developed with our own technology; exported to many countries

Our products are developed with our own technology; more effective than foreign system windows; able to earn royalty by exporting them

Premium Sliding Window

The Hidden-Rail System has a nice & clean appearance

Window technology optimized for Monsoon climate

Window technology optimized for noisy areas

Window technology optimized for areas with high levels of fine dust



1 AWD-HR240

- Outside : Hidden-Rail System
- Inside : Flat-Rail System
- Excellent Energy performance
- High Price Product

Size (mm)

	W	H
Min.	550	700
Max.	2,000	2,000

Frame	Material	Certification
HR232 HR237, HR240	Aluminum, Aluminum + PVC	

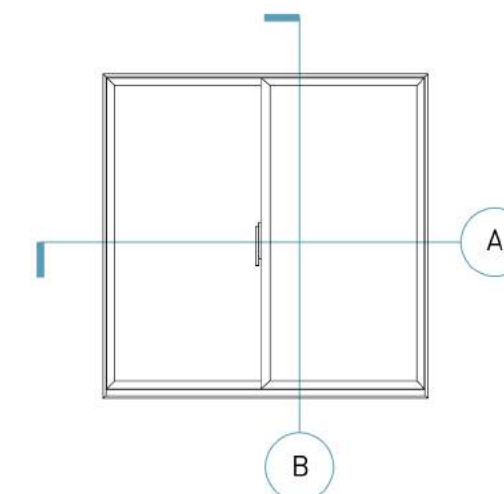

| KEY ELEVATION |

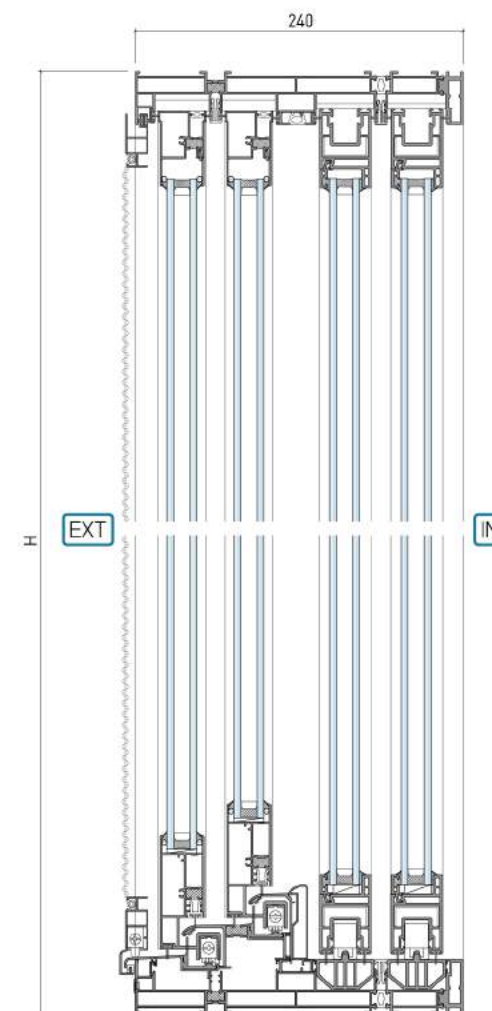

| VERTICAL SECTION |

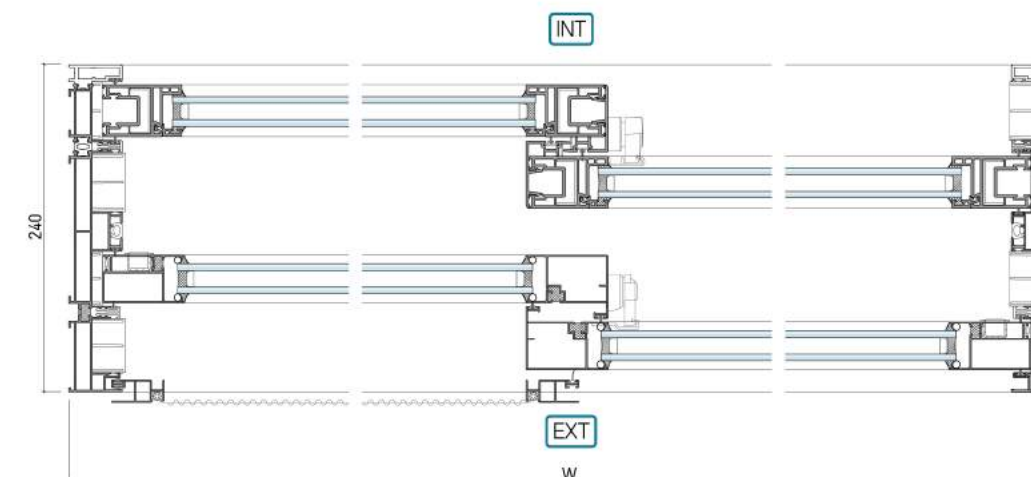

| HORIZONTAL SECTION |

2 AWS-HR180

• Excellent Single Sliding Window with 42mm triple low-e glass

■ Size (mm)

	W	H
Min.	550	700
Max.	3,000	2,500

Frame	Material	Certification
AWS-HR180	Aluminum	   

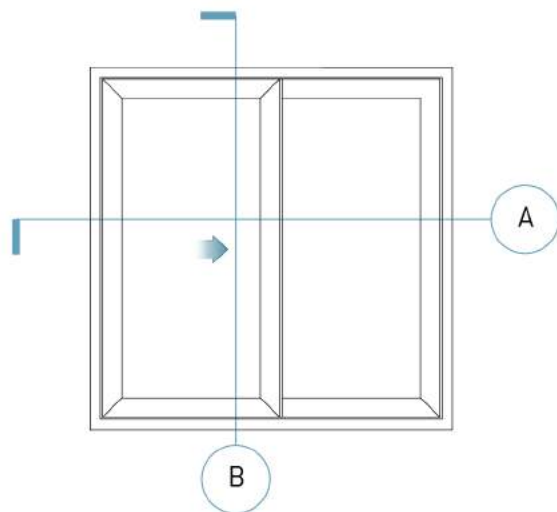
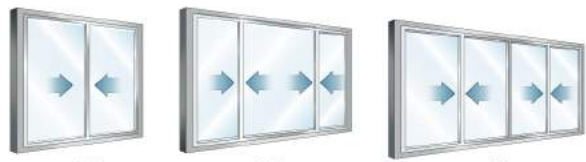

| KEY ELEVATION |

| SIZE |

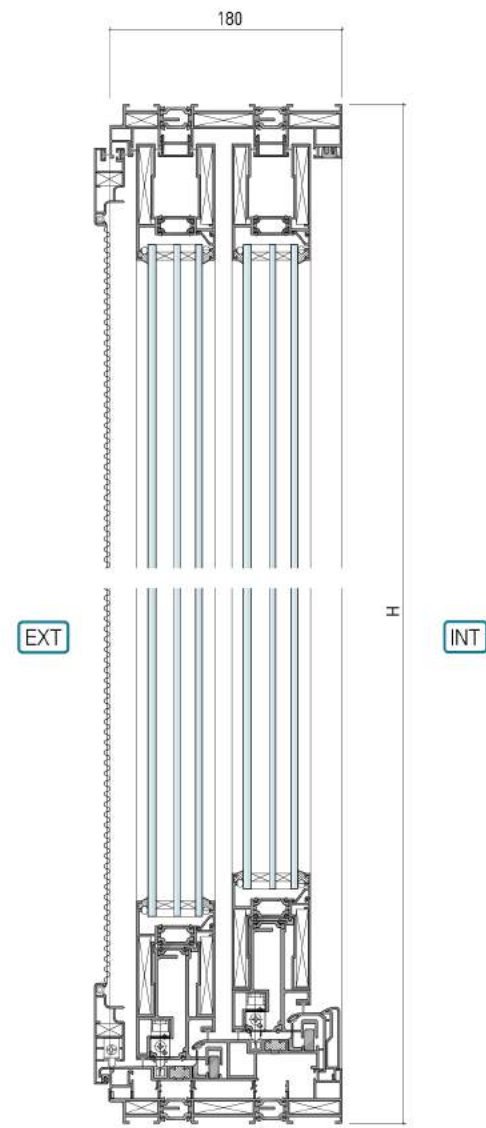

| VERTICAL SECTION |

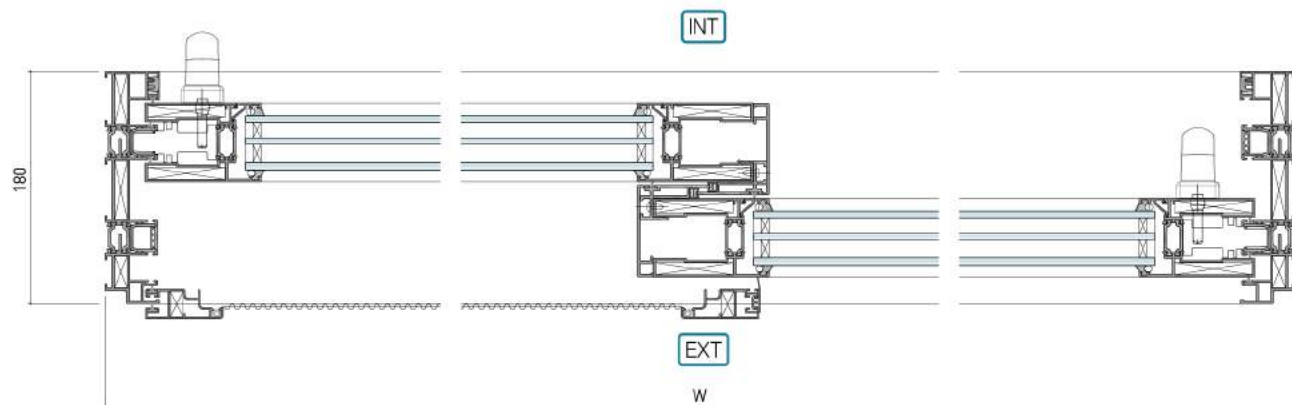

| HORIZONTAL SECTION |

180mm Sliding Window



Premium Sliding Window

3-1 HS -221S (6S TYPE)

- Wide openness : 70% open area
- Automatic drainage of rain water
- Application to Various designs

Size (mm)

	W	H
Max.	6,000	2,300

Type

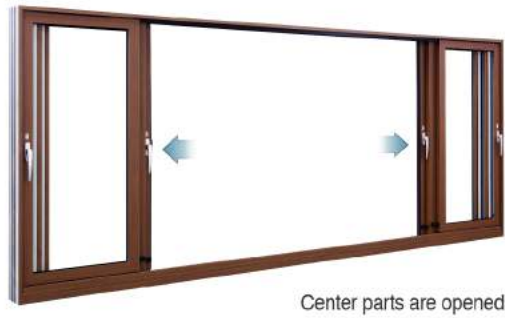

3-2 HS -221S (3S TYPE)



Size (mm)

	W	H
Max.	3,000	2,300

Type



4 AWD-HR232

- Relaxing and comfortable premium 232mm double sliding window
- Great stability with wide frame; good for mid- and large-size double sliding windows

Size (mm)

	W	H
Min.	550	700
Max.	3,000	2,300

Type



General Sliding Window



1 HS129S

- A 129mm sliding window – The basic model with broad applications

Outer windows for public and commercial buildings

Size (mm)

	W	H
Min.	550	700
Max.	2,000	2,000

Type



2 HS235D

- Relaxing and comfortable premium 235mm double sliding window
- Great stability with wide frame; maximizes insulating performances with double insulating bars

Size (mm)

	W	H
Min.	550	700
Max.	2,000	2,000

Type



Side-detach G-Type Crescent



Groove on the window grip for easy opening/closing



1-Tone Color



* The said colors are basic colors. They can differ from actual colors

The multiple certifications and intellectual copyrights we hold represent our advanced **Technology, Reliability and Creativity**

Certification

New Excellent Product (NEP)	New Excellent Technology (NET)	Government Procurement Excellent Product	Government Procurement Excellent Product	Green Certification
Excellent Performance Certification (EPC)	Environmental Labeling	KS	INNO-BIZ	Venture BIZ
Company-affiliated R&D Center	Green Remodeling Developer	Quality Management System	Environmental Management System	Certificate of Business with Disabled Employees

Awards

Commendation	Commendation	Commendation	Commendation
Commendation	Citation of Defense Installations Agency	Plaque of Appreciation	Energy Winner Award

Intellectual Property Right

Korean Patent	Korean Patent	Korean Patent	Korean Patent
US Patent	European Patent	Japanese Patent	Chinese Patent

SONUSYS



Reference Projects

Convenience in Life and Refined Design
 We present unique spaces created with our **system windows** which form a new window standard



SONUSYS SYSTEM WINDOW



Trade Fair BAU 2017 in Germany

SONUSYS took part in Messe Munchen BAU which was held in Munich, Germany. It is the largest construction material trade fair of Germany, which lasted from January 16th to 21st, 2017. It offered participants a chance to witness current trends in construction systems and materials.

With a lot of interest from many architects and those in window and construction material businesses from Europe, the Middle East, Africa and Asia, this event was a great opportunity for us to prove our advanced technology in the 'Hidden Rail System'. In particular, the auto-drainage system and advanced stair-style structure-based airtightness and water tightness have drawn big attention from the countries under oceanic climate or suffering from air pollution such as particulate matter (PM).



BAU 2017 | World's Leading Trade Fair for Architecture, Materials and Systems



BAU 2017 EXHIBITION

